

NOTES  
 Contractor must verify all dimensions on site before commencing any work or stop drawing.  
 If this drawing exceeds the quantities taken in any way the Architects are to be informed before the work is initiated.  
 Only figured dimensions to be taken from this drawing. Do not scale off this drawing.  
 Drawings based on Ordnance Survey and/or existing record drawings - design and drawing context subject to Site Survey, Structural Survey, Site Investigations, Planning and Statutory Requirements and Approvals.  
 Authorised reproduction from Ordnance Survey Map with permission of the Controller of Her Majesty's Stationary Office. Crown Copyright reserved.  
 Carey Jones Architects Limited Copyright.

This drawing originates from the CAD file:  
 REVISIONS  

Rev	Desc	By	Date	Ch
A	REVISED IN ACCORDANCE WITH LCC	GM	01.08.07	

24/412/05R

LEEDS CITY COUNCIL  
 Please refer to Decision Notice  
 - 3 AUG 2007  
**REVISED**

Refer to Architects drawings (20)250 for details of perimeter wall

Note:  
 Refer to Landscape Architects drawings for details of external treatment

Refer to Architects drawings (20)250 for details of retaining wall

Refer to Architects drawings (20)230 for details of existing lodge refurb

Refer to Architects drawings (20)250 for details of perimeter wall

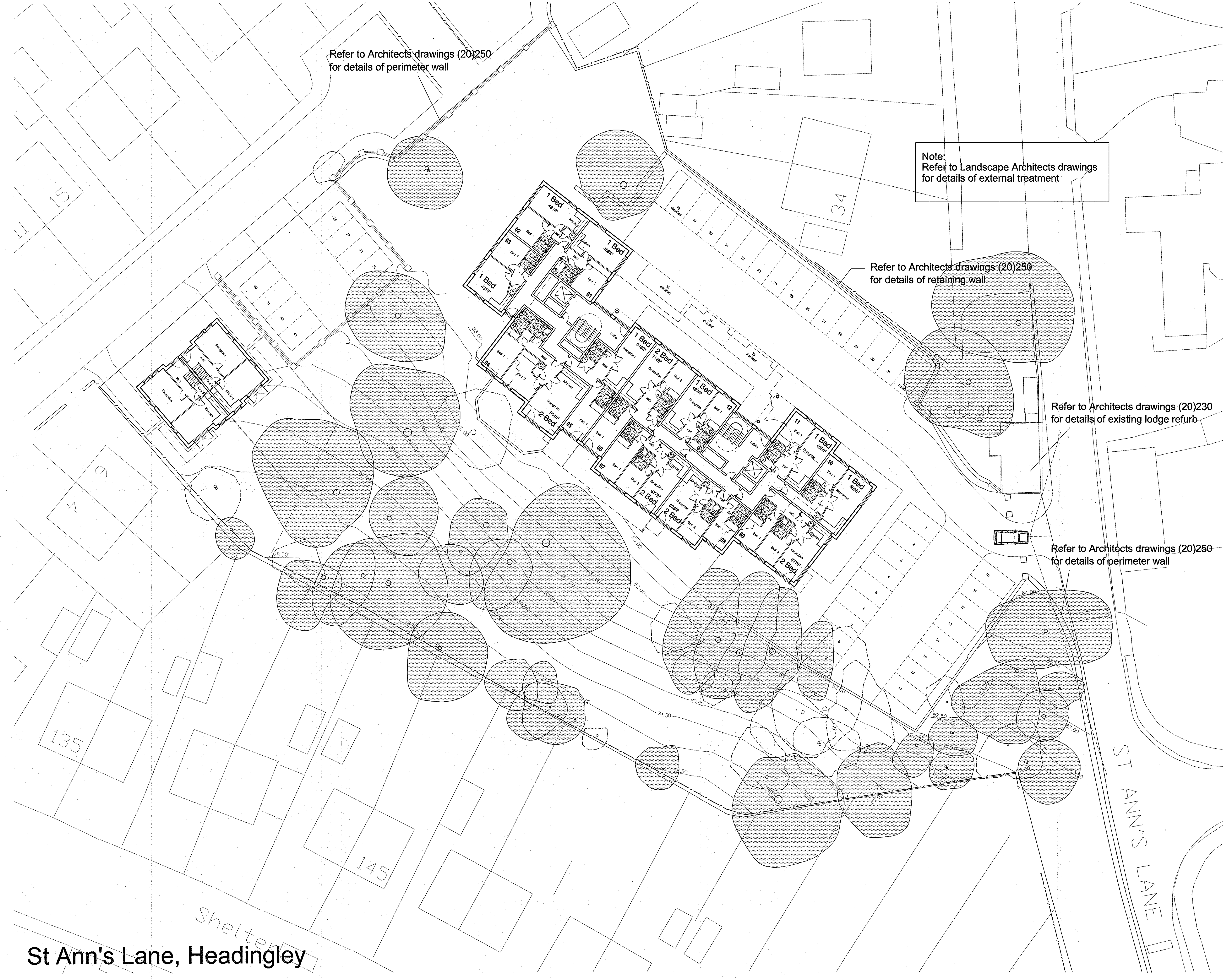

**CAREYJONESARCHITECTS**

Rose Wharf  
 78 East Street  
 Leeds  
 LS9 8EE  
 Tel +44 (0) 113 224 5000  
 Fax +44 (0) 113 224 5001  
 E-mail info@careyjones.com

Victoria House  
 Southampton Row  
 Bloomsbury  
 London  
 WC1B 5EA  
 Tel +44 (0) 207 269 9403  
 Fax +44 (0) 207 269 9401

Project:  
**ST ANN'S LANE  
 HEADINGLEY**  
 Title:  
**PROPOSED SITE PLAN**

Scale: 1:200@A1	Drawn by: GM
Date: AUG 07	Checked by:
Drawing No: 16,288 (00) 201	Rev: A

St Ann's Lane, Headingley